

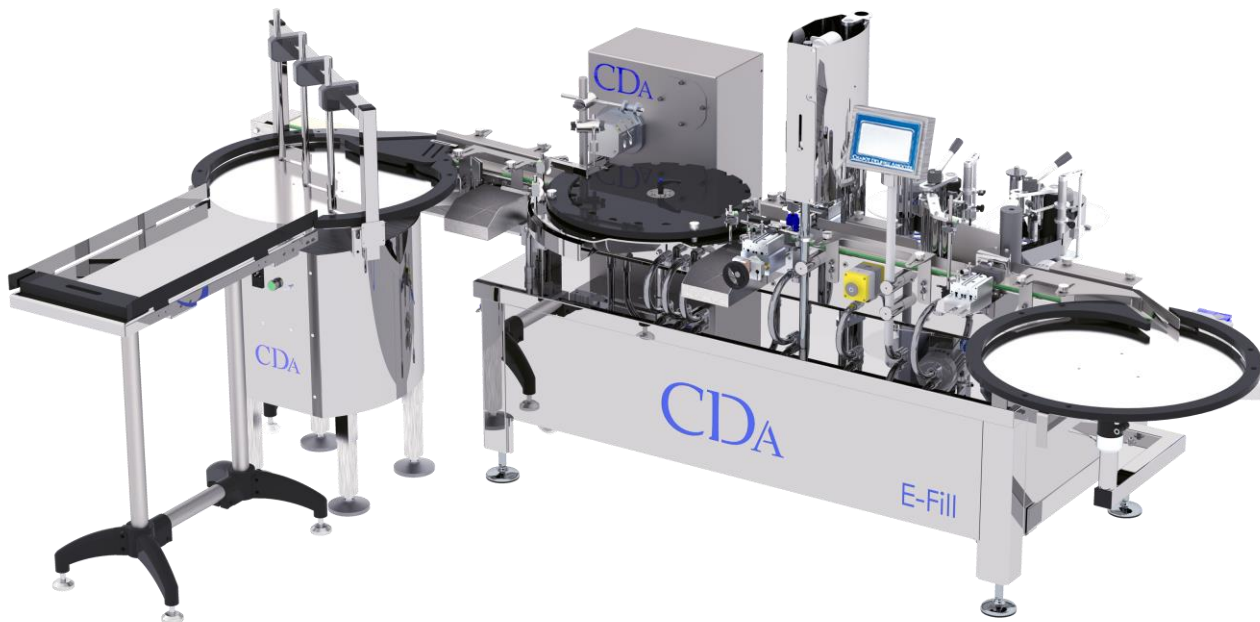

LABELING & FILLING SYSTEMS

E-FILL



Click [here](#) to see this machine's website page with more pictures and video

TECHNICAL DESCRIPTION	
Model	<i>E-Fill</i>
Products moving on conveyor	<i>From left to right</i>
Type of pump	<i>Peristaltic pump</i>
Type of label dispensers	<i>2 label dispensers for round products</i>
Label wind	<i># 4 - Left outlet</i>
Production rate	<i>1,200 to 1,500 products per hour (according to product size)</i>
Control	<i>Colorful digital display</i>
Power supply	<i>208 - 250 V Single Phase - 50/60Hz 16A</i>
Electrical power	<i>1 kW (depending on options)</i>
Compressed air consumption	<i>6 bars – 58 PSI</i>
Machine dimensions (L x W x H)	<i>3035 x 1581 x 1000 mm – 10 x 5.2 x 3.3 feet</i>
Conveyor height	<i>925 ±20 mm – 36.4 inches ±0.8 inches (different height available on demand)</i>
Weight	<i>250 kg – 550 lbs (depending on options)</i>

www.cda-usa.com

CDA USA Inc, 4310 Eubank Road, Richmond, VA 23231, USA –
Phone number: 804-918-3707 – Fax: 804-918-3670 - contact@cda-usa.com



LABELING & FILLING SYSTEMS

TECHNICAL CHARACTERISTICS

FILLING

MACHINE OUTFITTED WITH: Automatic centrifugal/impeller pump and electro-magnetic/mass flow meter filling machine:

◆ Programmer:

- Color Touchscreen display
- Adjustment of pump volume, speed and calibration after dosing through touchscreen.
- Minimum dose: (15 ml). Maximum dose: 1.32 Gal (2L). Programming unit: 0.03 oz (1 ml).



◆ Feeding pump:

- Self priming centrifugal/impeller pump in 316 L stainless steel, with FKM gaskets
- Pump body, turbine and shaft in 316 L stainless steel
- Mechanical set ceramic/graphic/NBR (FKM or EPDM on request)
- Adjustable flow from 105 to 264 Gal/h (400 to 1000 L/h)
- Switch to reverse flow
- 1" fitting gas in entrance (others fittings possible on request)
- Induction pipes and cannulas in option



◆ Magnetic flow meter:

- An electro-magnetic /mass flow meter in 316 L stainless steel, DN8 or DN15 outfitted with FKM gaskets
- Dosing accuracy +/- 0.5%
- Flow: minimum: 40 Gal/h (150 L/h) - maximum: 400 Gal/h (1,500 L/h)

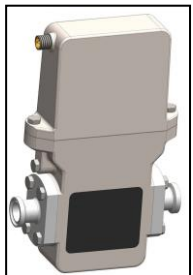

◆ Dosing valve and nozzle:

- Pneumatic dosing GEMU valve in 316 L stainless steel, with FKM gaskets
- Nozzle in 316 L stainless steel, with – no drip / no foam – feature
- Nozzle diameter: TBD
- Flexible hose, Tricoclair type between the flow meter and valve.

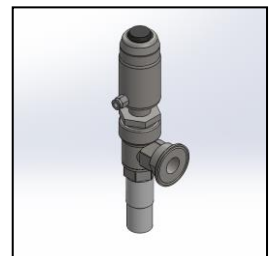

www.cda-usa.com

CDA USA Inc, 4310 Eubank Road, Richmond, VA 23231, USA –
Phone number: 804-918-3707 – Fax: 804-918-3670 - contact@cda-usa.com



LABELING & FILLING SYSTEMS

ROTATING STAR AND DISPENSING STATION **(TIP AND CAP)**



NB: Cap dispensing and pre tightening will be made manually. In the future, the tip and cap dispensing could be automatized in order to integrate an automatic dispensing system.

Technical description:

- ◆ Stainless steel conveyor 82.5 mm (4.33 inches) wide.
- ◆ Adapted system for products diameters from 20 to 70 mm (0.79 to 2.75 inches).
- ◆ Rotating star designed and made for each format of bottles.
- ◆ Speed control by Variable Frequency Driver.
- ◆ Dosing nozzle in stainless steel – going up and down by pneumatic air cylinder.
- ◆ Pushing system by pneumatic air cylinder as well – height adjustment possible.
- ◆ Automatic control sensors to check if the tip and/or cap are on the bottle.
- ◆ 2 stainless steel bowls in order to make the tips and caps easily accessible.

www.cda-usa.com

**CDA USA Inc, 4310 Eubank Road, Richmond, VA 23231, USA –
Phone number: 804-918-3707 – Fax: 804-918-3670 - contact@cda-usa.com**



LABELING & FILLING SYSTEMS

CAPPING

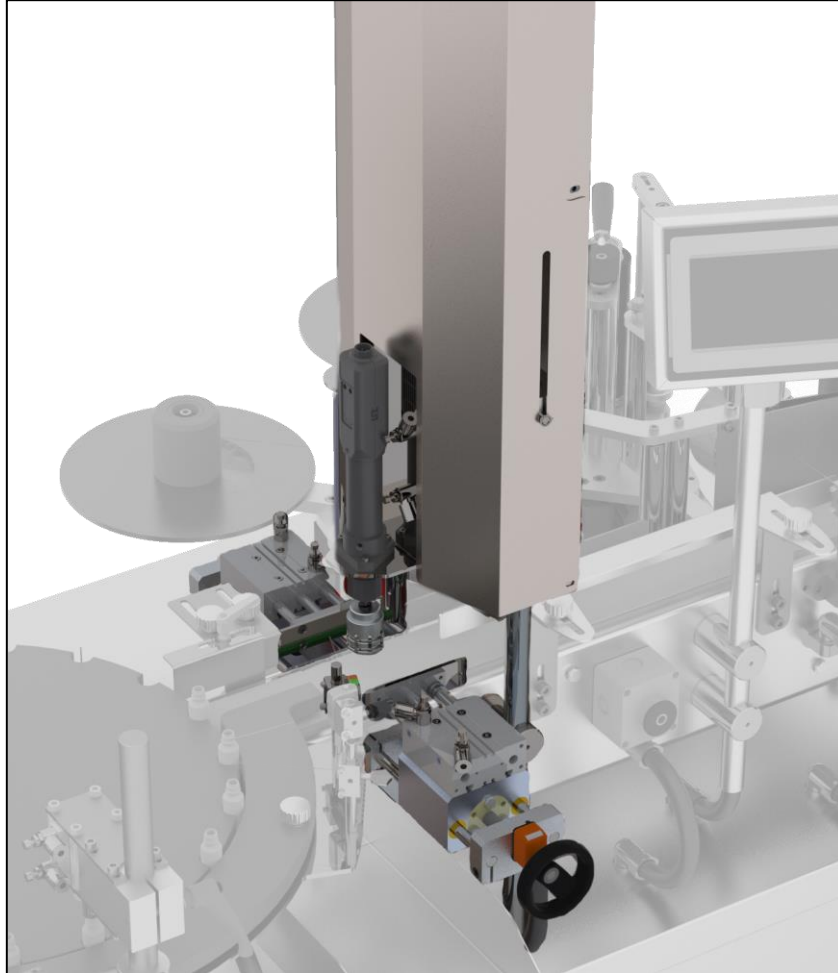

Technical description:

- ◆ Products lock system by pneumatic cylinder for cylindrical products anti-rotation.
- ◆ Capping with double guiding system with adjustable height.
- ◆ Low tension electric capper (320 tours / min) with adjustable capping head without tools (0.7 à 3Nm).
- ◆ Capping head made regarding to your cap (diameter, height...).

www.cda-usa.com

CDA USA Inc, 4310 Eubank Road, Richmond, VA 23231, USA –
Phone number: 804-918-3707 – Fax: 804-918-3670 - contact@cda-usa.com



LABELING & FILLING SYSTEMS

LABELING

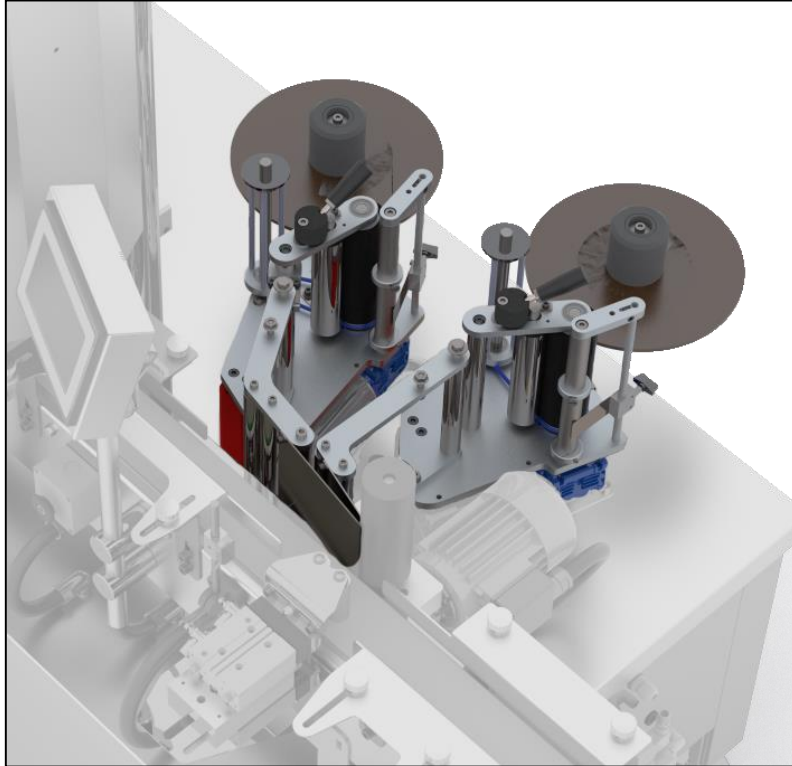

The “3 points” technology allows the bottles to be hold in between 3 rollers while spinning, which gives a better labeling and smoothing quality of the label on the bottle; with this technology we avoid any risk of bubbles or wrinkles on the applied label.

- ◆ Label dispensers built on a motorized height regulation system driven through the digital display.
- ◆ Product(s) pusher adapted to the material, shape and rigidity to the product(s) we have to label.
- ◆ Smoothing roller 61 mm (2.4 inches) diameter adapted to the product(s).
- ◆ Up to 50 memories from the digital display.
- ◆ Clear labels gap sensor (Option).
- ◆ Heights setting memories. (Option).

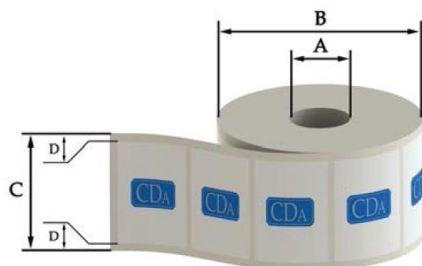

WINDING DIRECTION: #4 LEFT OUT

Label reel dimensions:

- A : Inside diameter = 75mm (2.95 inches)
- B : Max. Outside diameter = 260mm (10.24 inches)
- C : Max. Band height = 160mm (6.30 inches) (Higher on demand)
- D : Space between labels = 3-5mm (0.12-0.20 inches)

Minimal paper quality: 90g (3.17oz)

Note: The rolls have to be stored in a dry place between 15°C and 18°C (59°F and 65°F).

Machine delivered with EC Standards

www.cda-usa.com

CDA USA Inc, 4310 Eubank Road, Richmond, VA 23231, USA –
Phone number: 804-918-3707 – Fax: 804-918-3670 - contact@cda-usa.com



LABELING & FILLING SYSTEMS

INLET ROTATING TABLE



Technical description:

- ◆ Rotating table diameter 700 mm (27.5 inches) – 1,000 mm in option (39.4 inches).
- ◆ Brackets adjusted to products diameter to feed on machine conveyor.
- ◆ Inverter driver to adjust the rotation speed.

OUTLET ROTATING TABLE

Technical description:

- ◆ Rotating table diameter 700 mm (27.5 inches) – 1,000 mm in option (39.4 inches).

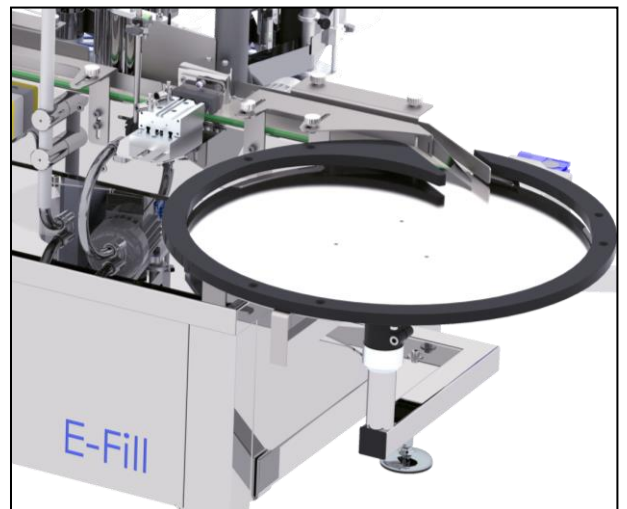

www.cda-usa.com

CDA USA Inc, 4310 Eubank Road, Richmond, VA 23231, USA –
Phone number: 804-918-3707 – Fax: 804-918-3670 - contact@cda-usa.com



LABELING & FILLING SYSTEMS

Enercon Induction sealer



**Innovative People.
Ensuring Your Success.**

Page 2 of 3 **PROPOSAL #158634**
+1.262.255.6070 / www.enerconind.com

Super Seal 75

Application	Cap Style (mm)	Line Speed
Liquids	22,28,38 CRC	Up to 60 feet/minute

The industry leading **Super Seal™** features microprocessor control and easy-to-use plug-in sealing heads. Its advanced power supply circuitry and innovative design combine to deliver outstanding reliability and performance.

- Advanced IGBT circuitry
- High efficiency plug-in sealing head
- Advanced control panel with digital meter
- Local/Remote mode for power on/power off
- NEMA 4/IP 65 rated for washdown
- Input voltage: 240V +/- 10%, single phase (208V available)
- Ambient temperature range: 0-40°C (32-104°F)



Including :

- Mobile cart
- Spare parts kit
- Mounting Yoke
- Adjustable sealer mount to accommodate a wide range of products heights

www.cda-usa.com

CDA USA Inc, 4310 Eubank Road, Richmond, VA 23231, USA –
Phone number: 804-918-3707 – Fax: 804-918-3670 - contact@cda-usa.com



LABELING & FILLING SYSTEMS

The E-fill	QTY
MACHINE BASE INCLUDING: <ul style="list-style-type: none"> • Motorized stainless steel conveyor built on stainless steel frame. Includes electric cabinet managed by PLC. • Anti-jam sensors • HMI screen for easy adjustment and product counting • Machine on adjustable feet • One star wheel 	1
Stainless steel conveyor - Chain width 3.25 inches	INCLUDED
Feeding table 27.5 inches pharma finish with loading tablet	1
Electromagnetic flowmeter built in stainless steel 316L, DN8 or DN15 tubing size with FKM gaskets. Accuracy +/- 0.5% off the requested volume.	1
<ul style="list-style-type: none"> • Impeller pump • Pump frame and shaft stainless steel 316L • Impeller in EPMD • Adjustable flow from 100 gallon to 265 gallon per hour 	1
Star wheel for one product diameter	1
Second nozzle with electromagnetic flowmeter (flowmeter, valve and nozzle)	1
VS400 Capping station including: <ul style="list-style-type: none"> • Gate system to stop and manually dispense a cap on the bottle. Cap sensor to ensure its position before it releases it • Symmetric double pneumatic cylinder graduated to block and secure the product while it is torque capped • Includes one capping head 	1
One label dispenser for front labels (maxi label height 160 mm = 6.30 inches) built on a motorized height regulation system driven through the digital display	1
Ultrasonic fork sensor for clear label	1
Clutch support plate	1
End of the line conveyor including transfer belts and accumulation table	1
Inkjet Video Jet VJ1220	1
Enercon induction sealer	1
Extended warranty of 2 years (3 total)	1