

**A
STEP
BY STEP
VARIABLE LENGTH
CARTONING
SYSTEM**



**CARTONING
MACHINERY**

54L CONVEY-O-MAT

82 CARTON CLOSER

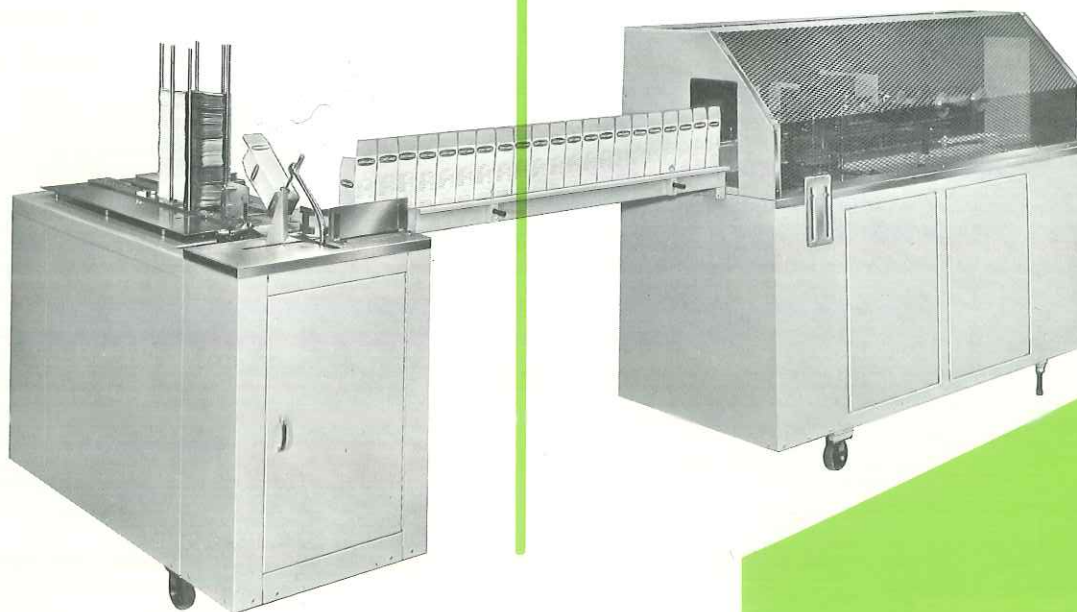

VERTICAL CONVEY-O-MAT

THE 54L is an inexpensive, dependable, quality carton set-up machine with much to offer. It is compact, and caster mounted, for convenient use wherever needed. Cartons are formed, tucked and propelled vertically through the loading conveyor at speeds up to 3600 per hour. This rugged Convey-O-Mat will run the same size carton for years, with little or no adjustment, yet many different kinds of cartons may be run, some without attachments. Change time is usually from five to fifteen minutes for an experienced mechanic. Change parts for different cartons and sizes are inexpensive and available on short notice. The Convey-O-Mat is unsurpassed for test marketing. For special cartons, factory modified machines can be ready to run in your plant for one half or less the price and delivery time of a custom built cartoner. A wide variety of standard attachments offers many added functions.

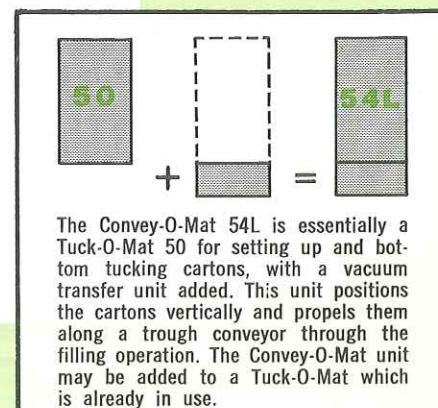
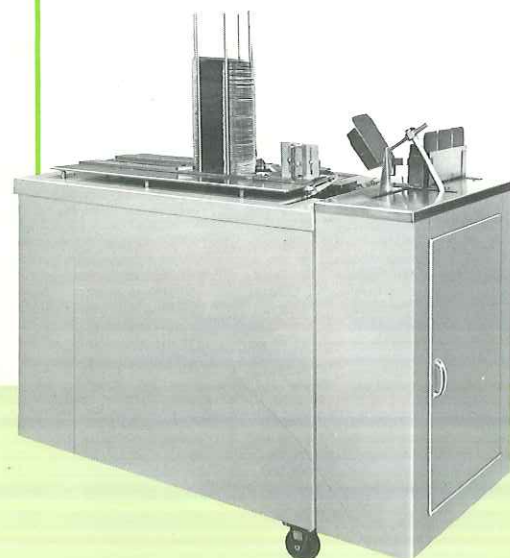

HANDLES ALL THESE STYLES OF CARTONS... AND MORE!

REVERSE TUCK

The basic 54L machine is designed to run this style of carton.

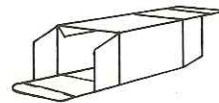

STRAIGHT TUCK ATTACHMENT

Easily interchanged with reverse tuck. For straight tuck cartons, use of 54L Coding Accessory is limited to Front Panel III or Right Side Panel IV.

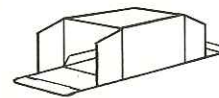

FLAP GLUING ATTACHMENTS

Two spot pattern gluing for dust flaps of straight or reverse tuck cartons. Also single line glue pattern for seal-end cartons. For top and/or bottom sealing.

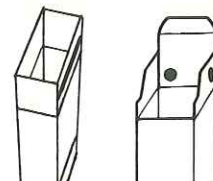

PARTITION

No attachment is necessary to run built-in partition cartons which are properly designed. Our engineering specialists will work with you to resolve your technical problems.

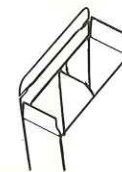

4-FLAP INTERLOCKING

Used where additional strength is required. Regular reverse tuck cartons may be run without removing the 4-flap attachment.



WINDOW

Many varieties of properly designed transparent window or die-cut cartons can be run without any attachment.

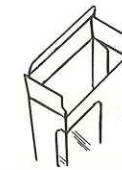

Scale: 1/2" to 1"

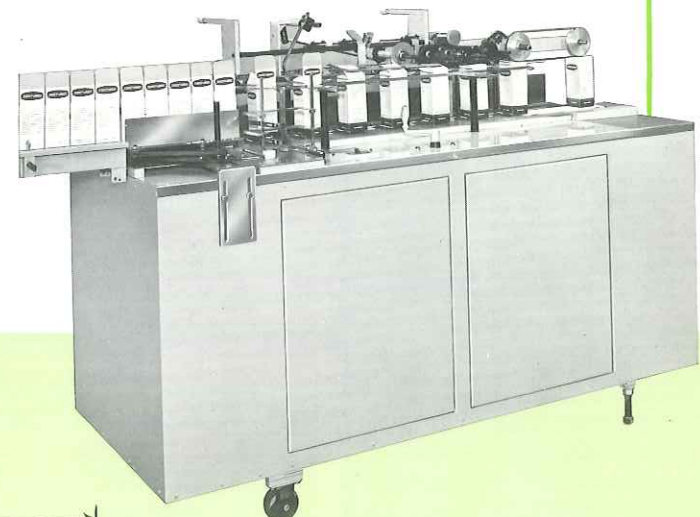

VERTICAL CARTON CLOSER

THE TROUGH TYPE LOADING CONVEYOR is available in standard lengths of 2', 4', 6', 8' or 10'. The addition of power driven conveyors and turntables can provide virtually unlimited length and orientation of a cartoning system.

THE MODEL 82 CARTON CLOSER completes the system. It accepts filled cartons at any speed up to its pre-adjusted rate. Maximum speed: 60 cartons per minute. No change parts are necessary to run different sizes of cartons within the standard size range of the machine. A set of change parts to convert from reverse tuck to straight tuck style of cartons is included as standard equipment. Change time is usually from ten to twenty minutes for an experienced mechanic.

A UNIQUE ADVANTAGE of this building block approach to semi-automatic cartoning is that the units may be used separately or together, and may be purchased at different times, as needed.

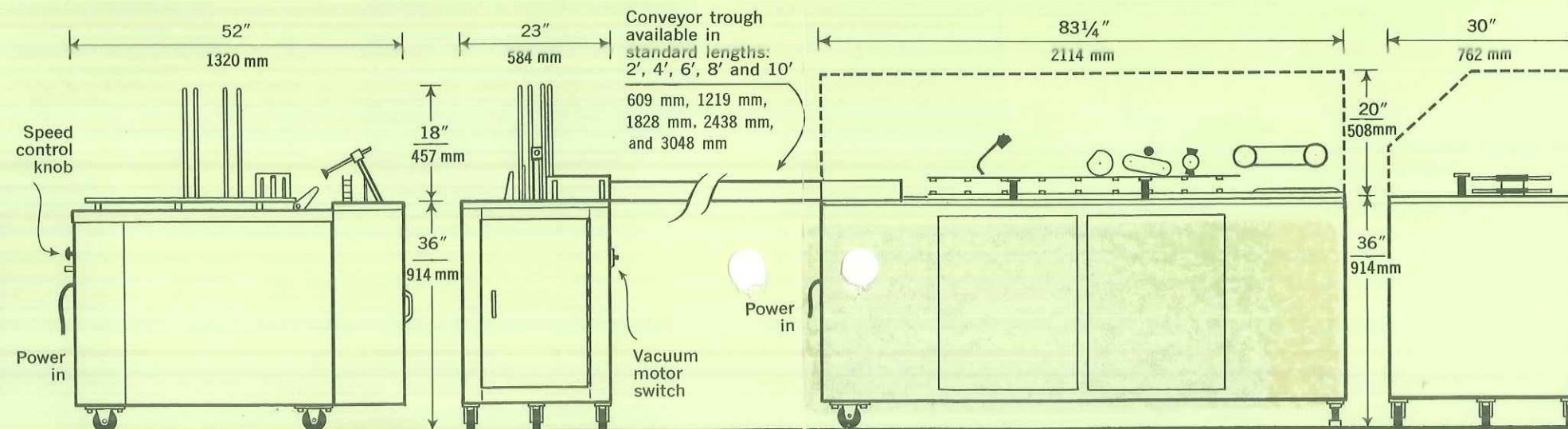

BIVANS CONVEY-O-MAT 54L

Drive motor	1/3 hp, 60 cycle, 115 volt
Vacuum motor	1/4 hp, 60 cycle, 115 volt
Weight	Net: 430 lbs. Shipping: 600 lbs.
	Metric Net: 195.5 kg Shipping: 273 kg
Operating speed	30-60 per minute

BIVANS CARTON CLOSER 82

Drive motor	1/2 hp, 60 cycle, 115 volt
Weight	Net: 465 lbs. Shipping: 675 lbs.
	Metric Net: 211 kg Shipping: 306 kg
Operating speed	30-60 per minute

54L CONVEY-O-MAT

CARTON CLOSER 82

DEBOSSING #321 Debosses uses steel type for debossing without ink.

CODING #321 Coder, rugged, simple, versatile . . . for field or factory installation. Uses rubber plate or base lock type to print code numbers or product identification within 1½" x 1½" area on Right Side Panel IV, Back Panel I or Top Panel I (see diagram). For certain applications, metal type can be used for a maximum of two lines, each 1/16" x 1/2" long. Platen printing assures positive register, and type can be changed in minutes. Eliminate costly independent printing operations, inventory problems and overrun losses with the #321 coder.

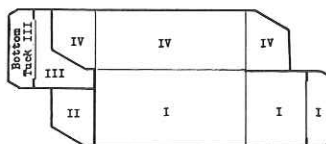

DEBOSSING

CODING

HOT MELT GLUING

COLD GLUING

54L - 82 CARTON DIMENSIONS

		Standard Carton Range	A	B	C	D	E
REVERSE TUCK		Minimum	7/8"	3/8"	1 1/4"	—	—
		Maximum	5"	3 1/2"	12"	17"	—
STRAIGHT TUCK		Minimum	7/8"	3/8"	2 1/2"	(Dependent on carton proportions) ←	
		Maximum	5"	3 1/2"	10"		
REVERSE TUCK	Metric measure in millimeters	Minimum	22	9.5	32	—	—
		Maximum	127	89	305	432	—
STRAIGHT TUCK		Minimum	22	9.5	64	(Dependent on carton proportions) ←	
		Maximum	127	89	254		

Extended carton ranges available on factory approval.

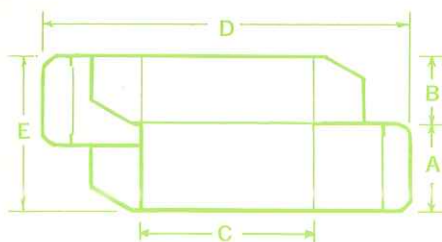

REVERSE TUCK

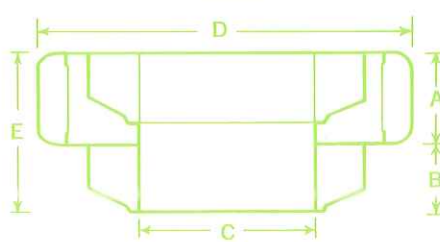

STRAIGHT TUCK

Product improvement is a continuing Bivans Corporation project. Therefore, all specifications are subject to change without notice.

LITHO IN U.S.A. 4-73

Distributors:



BIVANS CORPORATION

2431 DALLAS STREET, LOS ANGELES, CALIFORNIA 90031, U.S.
CABLE: BIVCORP • PHONE: (213) 225-4248



Distributed by

BIVANS CORPORATION
2431 DALLAS STREET, LOS ANGELES
CALIFORNIA 90031, U.S.A.
CABLE: BIVCORP • PHONE: (213) 225-4248