

ARPAC HANAGATA L-SERIES



PACKAGING SOLUTIONS THAT MEAN BUSINESS

ARPAC HANAGATA L-SERIES

AUTOMATIC L-BAR SEALER





STANDARD FEATURES

The ARPAC HANAGATA L-SERIES Automatic L-Sealer offers you the latest in shrink packaging technology, featuring a proprietary design that provides fast, user-friendly and reliable operation. Developed by Hanagata and ARPAC, pioneers in automatic L-Sealer technology, the flexible ARPAC HANAGATA L-SERIES is guaranteed to provide you with high quality packaging for retail display. This exclusive distribution partnership brings Hanagata's packaging innovations to North America with US based service and support.

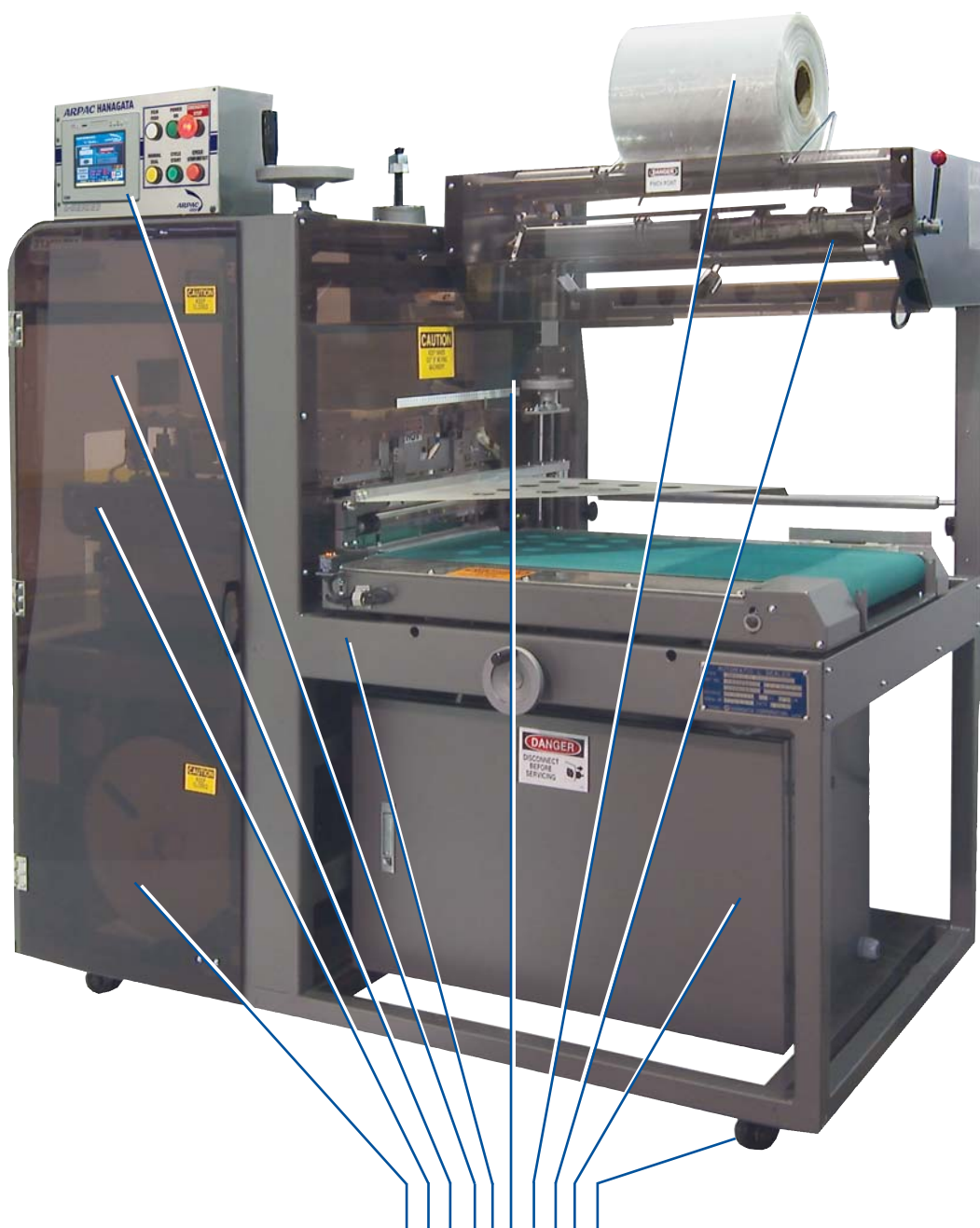

Worry-free Rewind System

Independent motor and closed-loop operation accommodates the lightest film gauges and narrow film tails – reducing your film requirement.



Unique Trim Takeaway

No more film tail breaks! Timing belts do not pull, but gently assist the film tail to the rewind system.



Safety Guards With Safety Door Interlock

Strong polycarbonate doors for product visibility and safety.



Variable Speed Conveyors With Soft Start Control

The latest in AC motor control technology. Precise digital motor overload monitor with accel/decel soft start control for reliable service without the maintenance required by other motor systems.

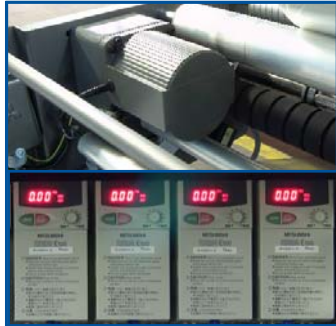

Heavy Duty Construction

Welded tubular frame, linear shafts and factory sealed bearings offer dependable operation in the most demanding production environments.



Heavy Duty Casters And Adjustable Height Legs

32 1/2" conveyor height adjustable to 36 1/2".



Allen-Bradley® Micrologix PLC

AC frequency motor control, circuit breaker protection (no fuses) and solid state heater relays ensure optimum machine performance.



Standard Needle Perfs

Allows positive air evacuation during shrink process for the most uniform retail package.



Easy Load Film Cradle

Handles 24"CF width (L-18) and 30"CF width (L-26). Film threading from the front allows placement of machine against wall or in-line with conveyor system.



Quick Product Changeover

Simple hand crank adjustments to marked scale positions offer maximum flexibility with product changeover in just minutes!





COMPETITIVE ADVANTAGES

User-Friendly Control Panel

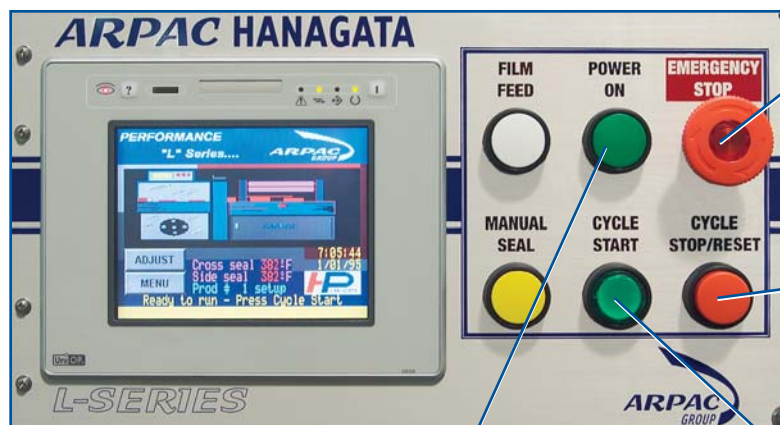

Emergency Stop Push Button

Immediately stops all machine operations. Must be released and reset to continue operation.

Cycle Stop/Reset Push Button

Stops the cycle of the machine and resets the controller after an emergency stop or machine fault.

Manual Seal Button and Film Feed Push Button

Provides manual control during product setup.

Cycle Start Push Button

Starts the automatic cycle of the machine. The working indicator will illuminate when the machine is in the cycle mode.

User-Friendly Color Touch Screen Operator Interface

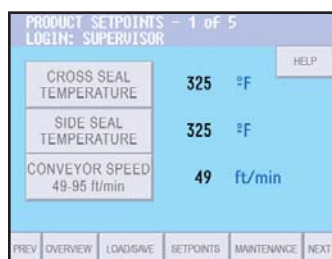

Easily Adjust Wrapping Parameters Such As Sealing Temperatures



Monitor System Performance



Seal Head Calibration Automatically Determines Ideal Seal Closing Speed

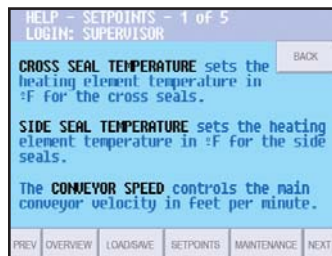

Help Screen

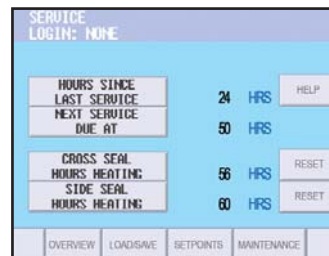

Check the Number of Hours a Machine Has Been Run And When Periodic Maintenance Is Due

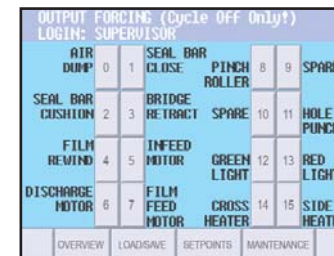

Output Forcing Screen

Innovative Pinch Roller Design



An innovative pinch roller design gently pulls “raw” film ahead of seal bar. Film breaks are eliminated on even the lightest film gauges. Precise control of the film web reduces film width requirement for most products.

Stroke Limiting Adjustable Seal Height

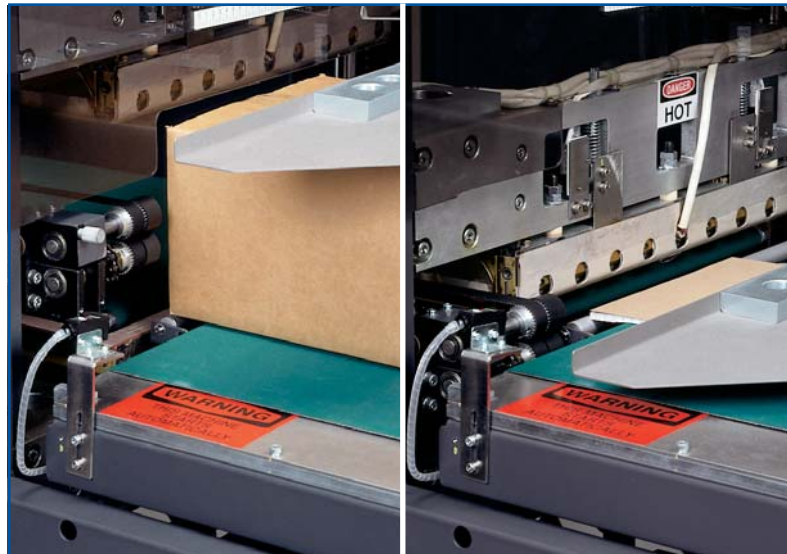

A single adjustment provides a centered seal for best product appearance, while limiting seal head stroke for the fastest production speeds. A proprietary “Seal Height Calibration Sequence” measures seal head height and automatically determines proper seal head cushioning for all seal heights.

Guillotine Style Seal Head

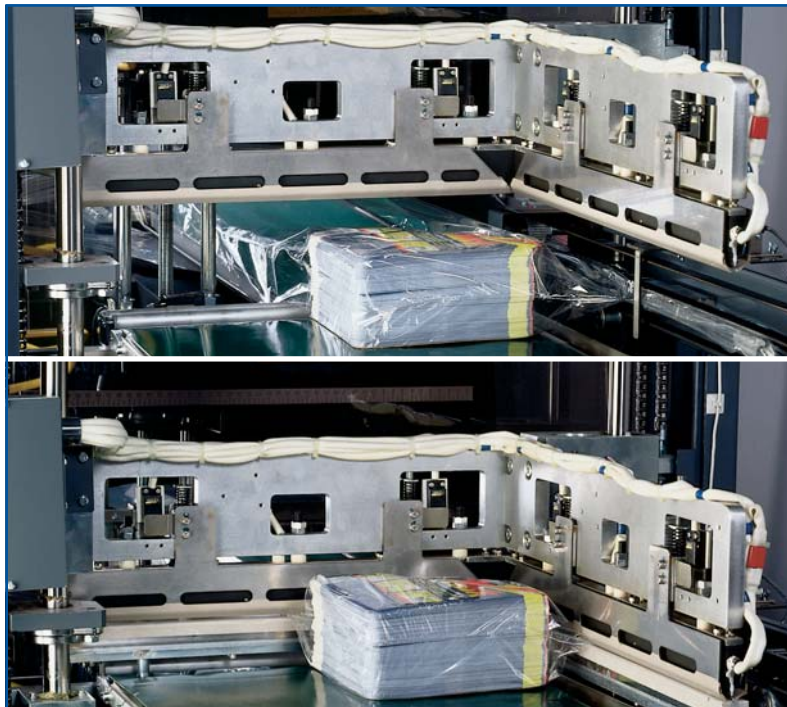

A Guillotine style seal head provides consistent seal strength for all product profiles. Vertical movement using linear shafts, bearings and reciprocating chains, is proven to be a superior sealing method eliminating the scissor action and linkages associated with pivot style systems.



SPECIFICATIONS

L-18

Speed*

- Max. packaging speed: 40 PPM based on 7" W x 4" L x 1" H product
- Variable conveyor speed: 45-90 FPM

Power Requirements

- Electrical: 230V (AC), 1Ph, 60Hz, 15A
- Pneumatic: 80 psi, 1 SCFM

Seal Dimensions

- 17 3/4" W x 19 1/2" L

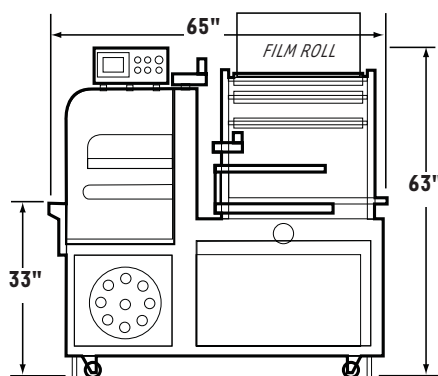

Product Range**

- 1 1/2" to 15" width across machine (AM)
- 4" to 18 1/2" length down machine (DM)
- 1/4" to 6" high
- 25 lbs. max. package weight
- Package width + height cannot exceed 17 3/4"
- Package length + height cannot exceed 19 1/2"

Film Size***

- 24" centerfold maximum, 11 1/2" diameter, "B" wind

Gross Shipping Weight

- 1,170 lbs.

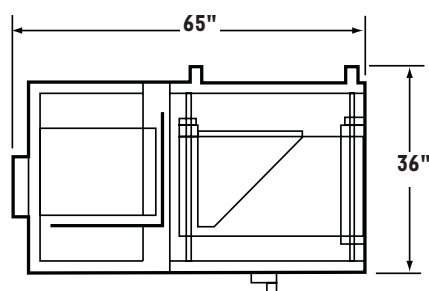

L-26

Speed*

- Max. packaging speed: 40 PPM based on 7" W x 4" L x 1" H product
- Variable conveyor speed: 45-90 FPM

Power Requirements

- Electrical: 230V (AC), 1Ph, 60Hz, 15A
- Pneumatic: 80 psi, 1 SCFM

Seal Dimensions

- 21 1/2" W x 27 1/2" L

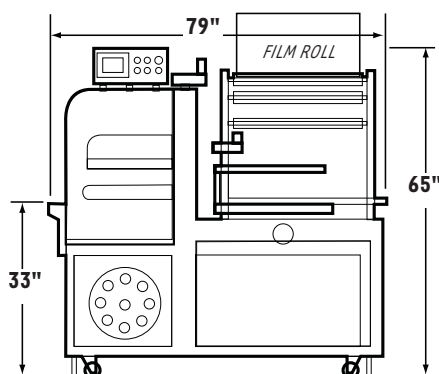

Product Range**

- 1 1/2" to 19" width across machine (AM)
- 4" to 26 1/2" length down machine (DM)
- 1/4" to 8" high
- 25 lbs. max. package weight
- Package width + height cannot exceed 21 1/2"
- Package length + height cannot exceed 27 1/2"

Film Size***

- 30" centerfold maximum, 11 1/2" diameter, "B" wind

Gross Shipping Weight

- 1,600 lbs.

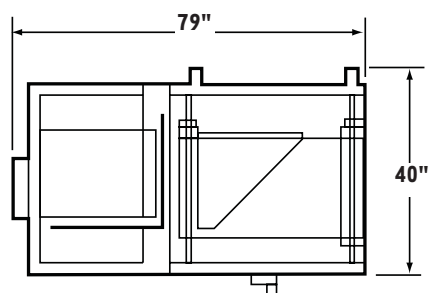

* Production speed depends on product size, stability, and film characteristics

** Package maximums cannot occur together

*** Sizing formula: $W + H (1" \text{ min.}) + 3" = \text{CF film width.}$
For products over 3" high, use $W + H + 4 = \text{CF film width.}$

AVAILABLE OPTIONS

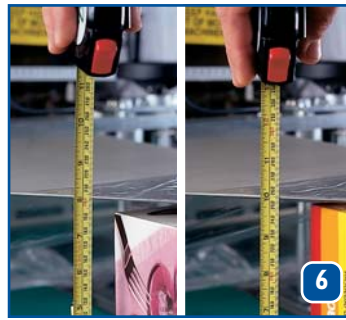

- 1 Slide Conveyor**
Allows transfer of small/unstable products. Minimum length 1 1/2". Includes stroke limit feature which allows fastest speeds as permitted by product characteristics.
- 2 Vertical Photoeye**
For use with products under 1/4" high or those not consistently detected with standard horizontal photoeye.
- 3 Pneumatic Hole Punch**
Pneumatic air cylinder with 1/4" round serrated tip punches hole through both top and bottom film layers. Additional air cylinder punch is easily added.
- 4 Lower Film Cradle**
Relocation of film cradle rollers to lower/rear of machine.
- 5 Auxiliary Emergency Stop Push Button**
Additional emergency stop push button can be located at infeed table or further upstream at operator station.
- 6 2" Seal Height Extension**
Increases L-18 product height capacity to 8", and L-26 product height capacity to 10".
- 7 Auxiliary Infeed Conveyor Control Relay**
Provides "dry contact" for synchronous operation with 6' lugged, 6' belted, collator or any auxiliary infeed system.
- 8 Infeed Product Guide**
Guides product into the seal area. Use with automatic infeed or round/unstable product.
- 9 Print Registration**
Runs print registered films. Closed-loop system for 1/4" accuracy.
- 10 Vision Series Shrink Tunnel**
Produces tightly-wrapped, aesthetically pleasing packages. Features a quality control viewing window.
Reverse Flow
Mirror image construction for product flow from left to right.
Machine Status Beacon
Green light - machine in cycle mode. Red light - for fault condition.
Stainless Steel
Stainless construction with food grade belting. Not intended for wash-down environment.
460 Volt Conversion
Step down transformer accepts 460 volt single phase power.
Powered Film Center Folder
For running single wound film.
Heated Seal Pads
Preheats seal pads for fastest sealing operation. Can increase cycle speeds 10-25%.



The ARPAC GROUP guarantees world class customer support. Our technicians are experts in every aspect of final assurance, installation, customer training and support for our entire line of equipment.

We provide over-the-phone trouble shooting, on-site diagnostics and repairs, and training so that your operators and maintenance crews have the knowledge to keep your machine running efficiently and productively.

The ARPAC GROUP houses an extensive inventory of spare parts with an 6 person call center, staffed daily and on an emergency basis, to better service our customers.

Call us to find out how we mean business for you.

