



# DCA400SSK

## WhisperWatt™ Generator

### WhisperWatt 400

Prime Rating: 320 kW (400 kVA)

Standby Rating: 352 kW (440 kVA)

60 Hertz

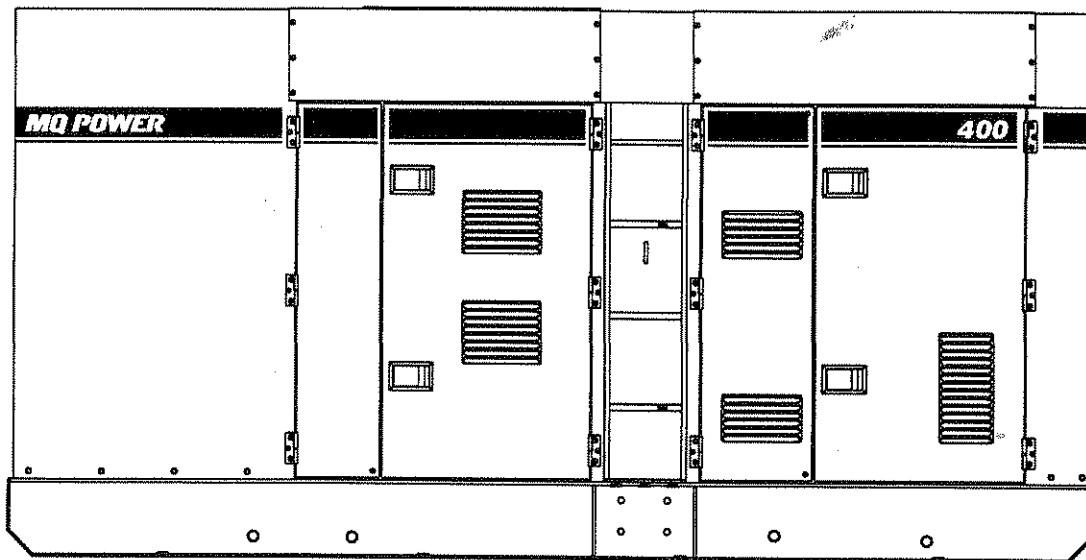

### WhisperWatt Standard Features

- Heavy duty, turbocharged, aftercooled, direct injection diesel engine provides maximum reliability.
- Brushless alternator reduces service and maintenance requirements and meets temperature rise standards for Class F insulation systems.
- Open delta alternator design provides virtually unlimited excitation for maximum motor starting capability.
- Automatic voltage regulator (AVR) provides precise regulation.
- Electronic governor system maintains frequency to  $\pm 0.25\%$ .
- Full load acceptance of standby nameplate rating in one step (NFPA 110, para 5-13.2.6).
- Sound attenuated, weather resistant, steel housing provides operation at 69 dB(A) at 23 feet. Fully lockable enclosure allows safe unattended operation.
- Internal fuel tank with direct reading fuel gauges are standard.
- Seven-stage powder coat paint provides durability and weather protection.
- EPA-MOH emissions certified.
- Complete engine analog instrumentation includes DC ammeter, oil pressure gauge, water temp. gauge, tachometer/hour meter, preheat indicator, manual engine speed control, emergency shutdown monitors, and emergency stop button.
- Complete generator analog instrumentation includes voltage regulator control, ammeter phase selector switch, voltmeter phase selector switch, AC voltmeter, AC ammeter, frequency meter, panel light, and circuit breaker.
- Automatic safety shutdown system monitors the water temperature, engine oil pressure, overspeed, and overcrank. Warning lights indicate abnormal conditions.
- Auto start/stop control allows generator to start automatically in the event of a commercial power failure.
- Complete power panel. Fully covered; three-phase terminals and single phase receptacles allow fast and convenient hookup for most applications including temporary power boxes, tools and lighting equipment. All are NEMA standard.
- Simultaneous single and three phase power.



# DCA400SSK

## WhisperWatt™ Generator

### Specifications

Generator	
Design	Revolving field Self-ventilated Drip-proof Single bearing
No. of Poles	4-pole
Excitation	Brushless with AVR
Standby Output	352 KW (440 KVA)
Prime Output	320 KW (400 KVA)
Generator RPM	1800
Voltage — 3Ø	208, 220, 240, 416, 440, 480V Reconnectable
Voltage — 1Ø	120, 127, 139, 240, 254, 277V Adjustable
Armature Connection	Star with neutral
Voltage Regulation (No load to full load)	±1.5%
Power Factor	0.8
Frequency	60 Hz
Insulation	Class F
Sound Level dB(A) Full load at 23 feet	69

Engine	
Make / Model	Komatsu / SA6D140AE
Starting System	Electric
Design	Direct injection Turbocharged Aftercooled
Displacement	15,240 cc
No. cylinders	6
Bore x Stroke (mm)	140 x 165
Gross Engine Power Output	539 bhp (402 kWm) Standby 490 bhp (365 kWm) Prime
BMEP	264 psi (1818 kPa) 240 psi (1653 kPa)
Piston Speed	1949 ft./min. (10 m/s)
Compression Ratio	16:1
Engine Speed	1800 rpm
Overspeed Limit	2100 rpm
Oil capacity gallons (liters)	16.1 (60.9)
Battery	12V 200Ah x 2 (24V System)

Fuel	
Maximum Fuel Flow (per hour)	39.6 gallons (150 liters)
Maximum Inlet Restriction (Hg)	2.9 in. (73.6 mm)
Maximum Return Restriction (Hg)	28.9 in. (735 mm)
Fuel Tank Capacity	129.5 gallons (490 liters)
Fuel Consumption	
At full load gph (lph)	20.4 (77.2)
At 3/4 load gph (lph)	15.8 (59.8)
At 1/2 load gph (lph)	11.0 (41.6)
At 1/4 load gph (lph)	6.6 (25.0)

Cooling	
Fan Load	10.7 HP (8.0 KW)
Coolant Capacity (with radiator)	18.1 gallons (68.4 liters)
Coolant Flow Rate (per minute)	87.2 gallons (330 liters)
Heat Rejection to Coolant (per minute)	10426 Btu (11 MJ) Standby 9289 Btu (10 MJ) Prime
Heat Radiated to Room (per minute)	3175 Btu (3 MJ) Standby 2815 Btu (3 MJ) Prime
Maximum Coolant Friction Head	5.0 psi (34 kPa)
Maximum Coolant Static Head	46 feet (14 meters)
Ambient Temperature Rating	95°F (35°C)

Air	
Combustion Air	1006 cfm (29 m³/min) Standby 971 cfm (28 m³/min) Prime
Maximum Air cleaner Restriction	30 in. H₂O (7.0 kPa)
Alternator Cooling Air	2797 cfm (79.0 m³/min)
Radiator Cooling Air	13241 scfm (375 m³/min)
Minimum Air Opening to Room	29.8 sq.ft (2.8 sq.m)
Minimum Discharge Opening	12.8 sq.ft (1.2 sq.m)
Maximum Static Restriction	0.5 in. H₂O (125 kPa)

Exhaust	
Gas Flow (full load)	2542 cfm (72 m³/min) Standby 2436 cfm (69 m³/min) Prime
Gas Temperature	1013°F (545°C) Standby 853°F (456°C) Prime
Maximum Back Pressure	40 in. H₂O (10 kPa)

Maximum Amps	
Rated Voltage	Maximum Amps
1Ø 120 Volt	888.9 amps (4 wire)
1Ø 240 Volt	44.4 amps (4 wire)
3Ø 240 Volt	962.3 amps
3Ø 480 Volt	481.1 amps

### Warranty\*

#### Komatsu Engine

12 months from date of purchase or 1000 hours (whichever occurs first).

#### Generator

12 months from date of purchase or 1000 hours (whichever occurs first).

\*Refer to the express written, one-year limited warranty sheet for additional information.

Backfeed to a utility system can cause electrocution and/or property damage. Do not connect to any building's electrical system except through an approved device. Specifications are subject to change without notice.



# DCA400SSK

## WhisperWatt™ Generator

### MQ POWER DECIBEL LEVELS

Our soundproof housing allows substantially lower operating noise levels than competitive designs. WhisperWatts are at home on construction sites, in residential neighborhoods, and at hospitals — just about anywhere.

- (90) — Subway / truck traffic
- (80) — Average city traffic
- (70) — Inside car at 60 mph
- (60) — Air conditioner at 20 feet
- (50) — Normal conversation

WhisperWatt at 23 feet

69.0  
DECIBELS

## Optional Generator Features

- ☐ **Battery charger** — provides fully automatic and self-adjusting charging to the generator's battery system.
- ☐ **Jacket water heater** — for easy starting in cold weather climates.
- ☐ **Coolant heater** — prevents coolant from freezing in cold weather applications.
- ☐ **Special batteries** — long life batteries provide extra engine cranking power.
- ☐ **Spring Isolators** — provides extra vibration protection for standby applications.
- ☐ **Fuel / water separators** — removes condensation from fuel for extended engine life.
- ☐ **Trailer mounted package** — highway legal trailer with electronic or surge brakes with single, double, or triple axle configuration. Extra capacity fuel tanks are also available.

## Optional Control Features

- ☐ **Remote speed adjust rheostat** — allows for engine speed adjustment from the control panel.
- ☐ **Low coolant level shutdown** — provides protection from critically low coolant levels. Includes control panel warning light.
- ☐ **Emergency stop switch**
- ☐ **Audible alarm** — alerts operator of abnormal conditions.
- ☐ **ICS-100™ digital control** — state of the art control panel that provides maximum reliability in a wide range of generator-set applications. This engine controller is fully loaded with features and provides complete engine-generator set monitoring and has a maximum operating temperature range of -40°C to 85°C.
- ☐ **ICS-100™ modem** — allows for complete remote monitoring, programming, and operation of a generator via a land-based phone line.

## Optional Fuel Cell Features

- ☐ **Trailer fuel tank** — a second fuel cell located in the trailer allows for extended run time.
- ☐ **Subbase fuel cells (single wall)** — Additional fuel cell for extended runtime operation.
  - ☐ 12 hours of minimum run time.
  - ☐ 24 hours of minimum run time.
- ☐ **Subbase fuel cells (double wall)** — Additional fuel cell for extended runtime operation. Contains a leak sensor, low fuel level switch, and a secondary containment tank. UL142 listed.
  - ☐ 12 hours of minimum run time.
  - ☐ 24 hours of minimum run time.
- ☐ **Environmental package** — provides extra protection to preserve the surrounding environment by using an integrated skid and custom designed environmental fuel tank. These packages not only contain fuel leakage but also any liquid that might leak from the engine such as lube oil or radiator coolant. All potentially hazardous liquids are contained without contaminating the surrounding area.



# DCA400SSK

## WhisperWatt™ Generator

### Dimensions

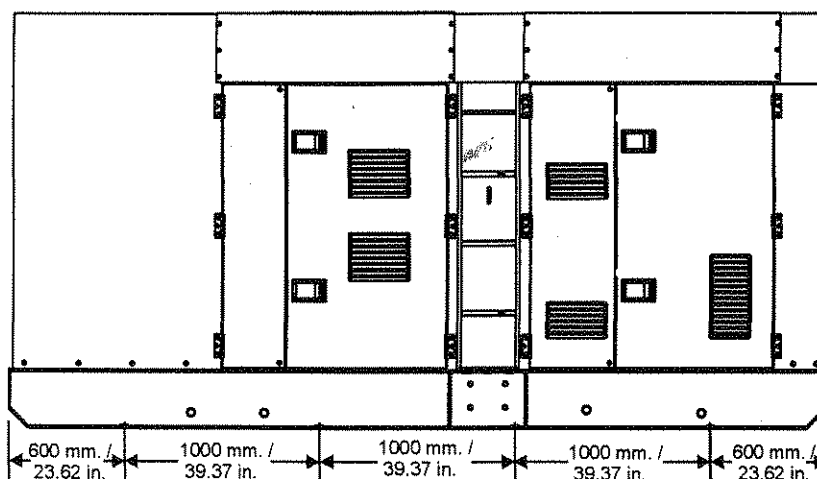
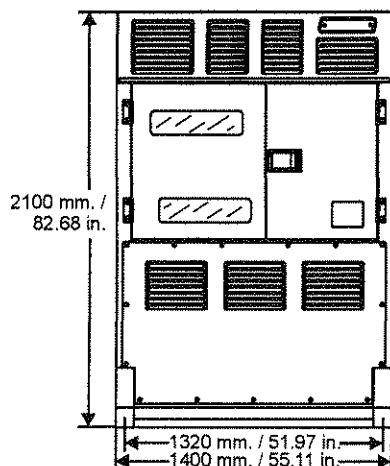

Weight	
Dry Weight	11,949 lbs.
Wet Weight	13,228 lbs.

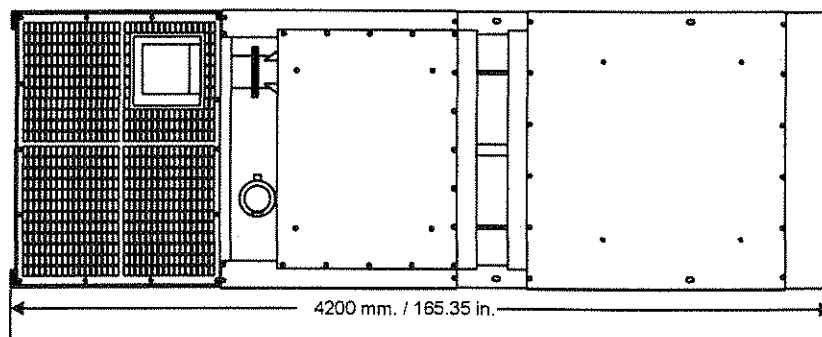

Manufactured by Denyo Co.

Your MQ Power dealer is:



**MQ POWER**  
A DIVISION OF MULTIQUIP INC.  
POST OFFICE BOX 6254  
CARSON, CA 90749  
310-537-3700 • 800-421-1244  
FAX: 310-632-2656  
E-MAIL: [mq@multiquip.com](mailto:mq@multiquip.com)  
WWW: [multiquip.com](http://multiquip.com)